



KZS-1M UNI

Universal Residual Current
Circuit Breaker with
Overcurrent Protection

EITHER WAY UP

 etigroup
www.etigroup.eu

ETI
SWITCH TO
A SAFE FUTURE

RCBO KZS-1M UNI

Either Way Up.

New universal KZS-1M UNI enables top and bottom, line and load compatibility for easy, fast either-way-up installations.

Enhanced Safety in Less Space

Two devices (MCB and an RCCB) in a single 1-module unit, switching active and neutral pole.

KZS-1M provides enhanced safety and protection for both people and electrical systems. It is commonly used in residential, commercial and industrial electrical installations and can be used in operating temperature down to -35°C .



Universal compatibility

The electrical supply can be connected **from top or bottom**.



The terminals accept not only **wires** but also time saving **busbars**.

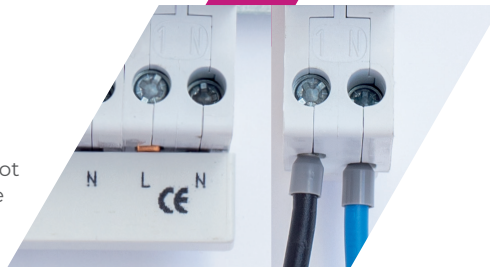

Special reset version

In the reset version, the toggle position clearly indicates the reason for tripping, preventing user mistakes and always making it clear whether the system turning off was intentional (manual) or the result of a fault in the electrical circuit.

Attention to detail

Increased opening on the N pole (size PZ2 screw drive) and **clearly marked terminals** ensure appropriate connection



Easy removal from existing busbar system



The option of **sealing** in the "ON" or "OFF" position.



Separate indication of contacts' real state (independent of the toggle position) ensures additional user safety.





The possibility of connecting to **SKN-type busbars**



Technical data

| | |
|---|-----------------------------------|
| Type | KZS 1M UNI |
| Rated voltage U_n | 230/240 V AC |
| Rated current I_n | 6-25 A |
| Minimum supply voltage U_{min} | 85 V |
| Rated frequency f_n | 50/60 Hz |
| Rated short-circuit capacity | 6.000 A |
| Back-up fuse | 100 A gG |
| Tripping characteristic | B, C |
| Rated residual current $I_{\Delta n}$ | 10, 30, 100 mA |
| Type of residual release | A, AC |
| Rated resid.making and breaking capac. $I_{\Delta m}$ | 1500A |
| Terminals | 1-10 mm ² , max. 1,5Nm |
| Terminal screw | M4 (Pozidrive PZ2) |
| Width | 18 mm |
| Mounting position | any |
| Standard | IEC 61009 |
| Length of neutral conductor | - |
| Operating temperature | -35°C ... +40°C |

KZS - 1M UNI

| I_n [A] | $I_{\Delta n}$ [A] | Type A | | Type AC | |  |  |
|--------------|-----------------------|------------|------------|------------|------------|---|--|
| | | Code No. B | Code No. C | Code No. B | Code No. C | | |
| 6 | 0,01 | 002176001 | 002176011 | 002176101 | 002176111 | 111 | 1/72 |
| 10 | | 002176002 | 002176012 | 002176102 | 002176112 | | |
| 13 | | 002176003 | 002176013 | 002176103 | 002176113 | | |
| 16 | | 002176004 | 002176014 | 002176104 | 002176114 | | |
| 20 | | 002176005 | 002176015 | 002176105 | 002176115 | | |
| 25 | | 002176006 | 002176016 | 002176106 | 002176116 | | |
| 6 | 0,03 | 002176021 | 002176031 | 002176121 | 002176131 | 111 | 1/72 |
| 10 | | 002176022 | 002176032 | 002176122 | 002176132 | | |
| 13 | | 002176023 | 002176033 | 002176123 | 002176133 | | |
| 16 | | 002176024 | 002176034 | 002176124 | 002176134 | | |
| 20 | | 002176025 | 002176035 | 002176125 | 002176135 | | |
| 25 | | 002176026 | 002176036 | 002176126 | 002176136 | | |
| 6 | 0,1 | 002176041 | 002176051 | 002176141 | 002176151 | 111 | 1/72 |
| 10 | | 002176042 | 002176052 | 002176142 | 002176152 | | |
| 13 | | 002176043 | 002176053 | 002176143 | 002176153 | | |
| 16 | | 002176044 | 002176054 | 002176144 | 002176154 | | |
| 20 | | 002176045 | 002176055 | 002176145 | 002176155 | | |
| 25 | | 002176046 | 002176056 | 002176146 | 002176156 | | |

Time current characteristics I/t

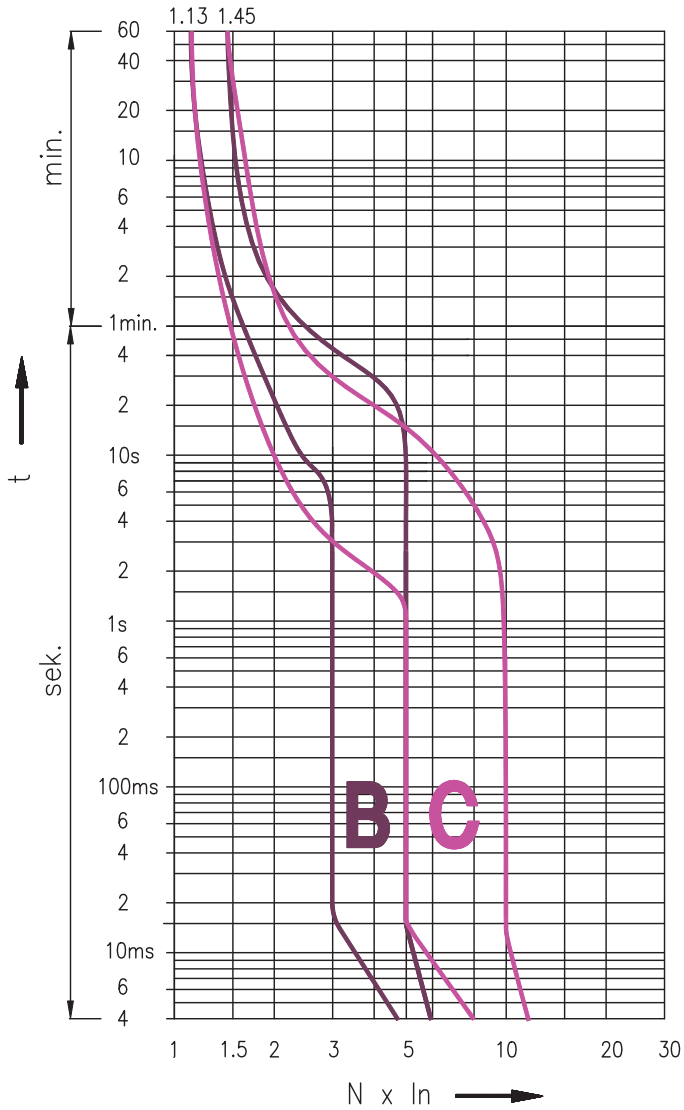

Melting energy characteristics I^2t

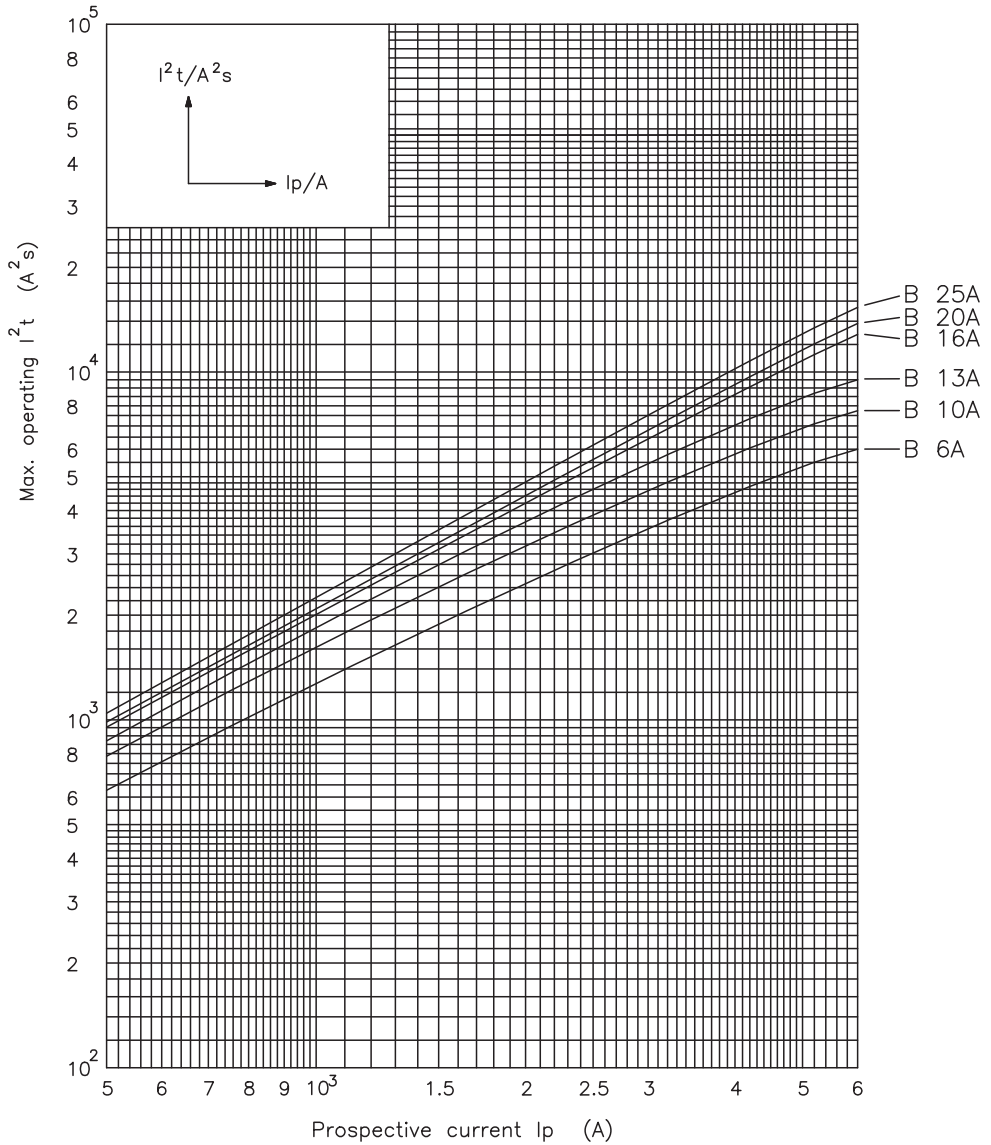

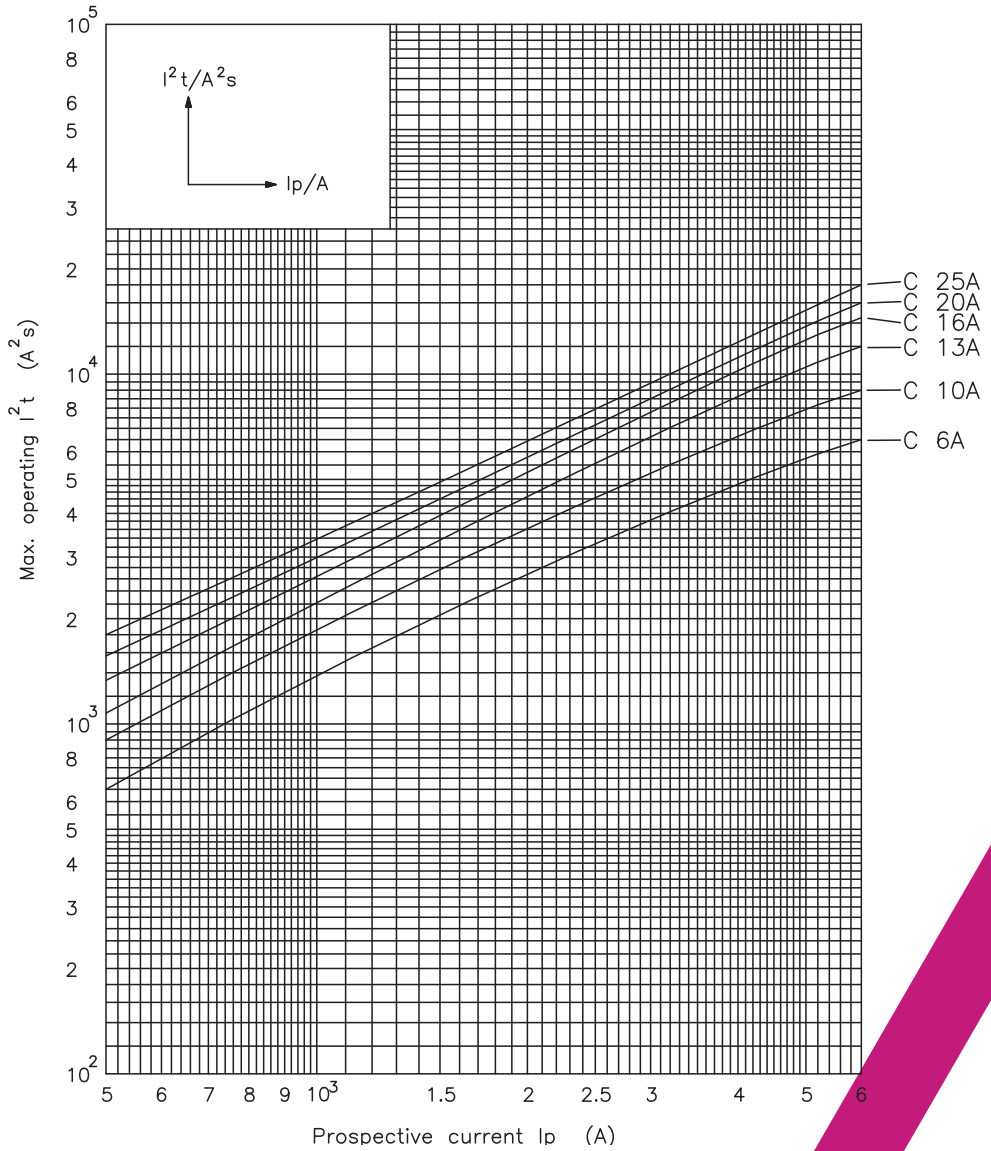

Cut-off current characteristics

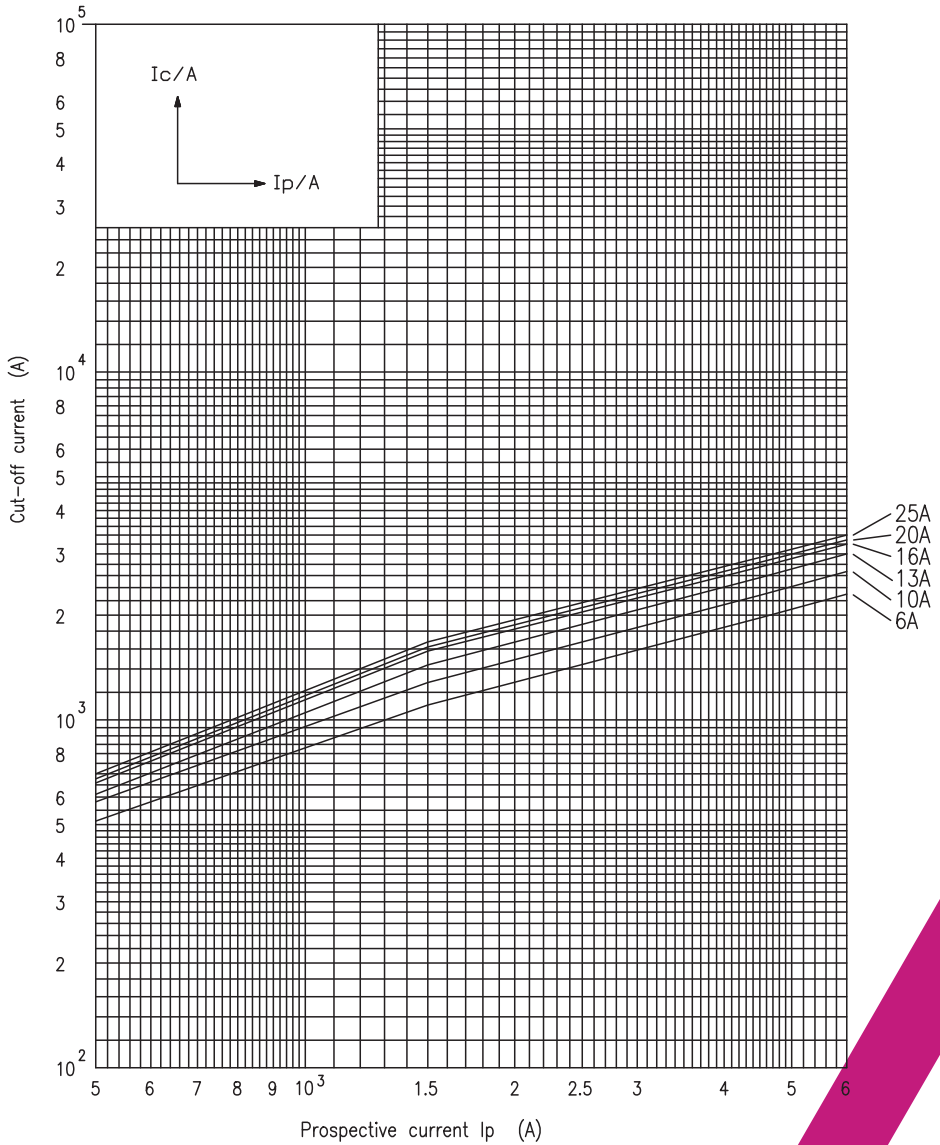

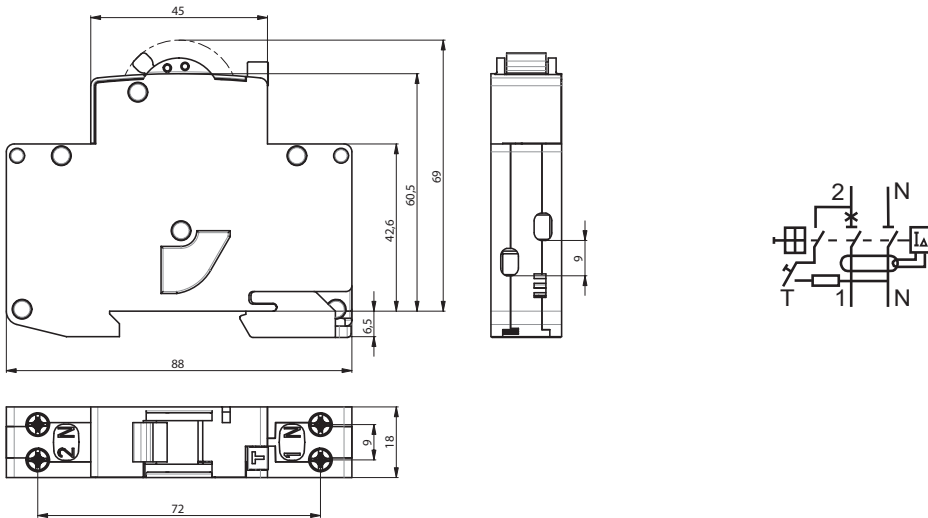

ETI is a European brand that guarantees the quality and reliability of its products in accordance with the highest European standards for electrical product manufacturers, business systems, suppliers, dealers, workers and everyone who cares about electricity.

ETI actively co-creates global trends and develops sustainable electrical solutions that will help maintain our environment for generations to come.

Discover the broad range of ETI products at
www.etigroup.eu

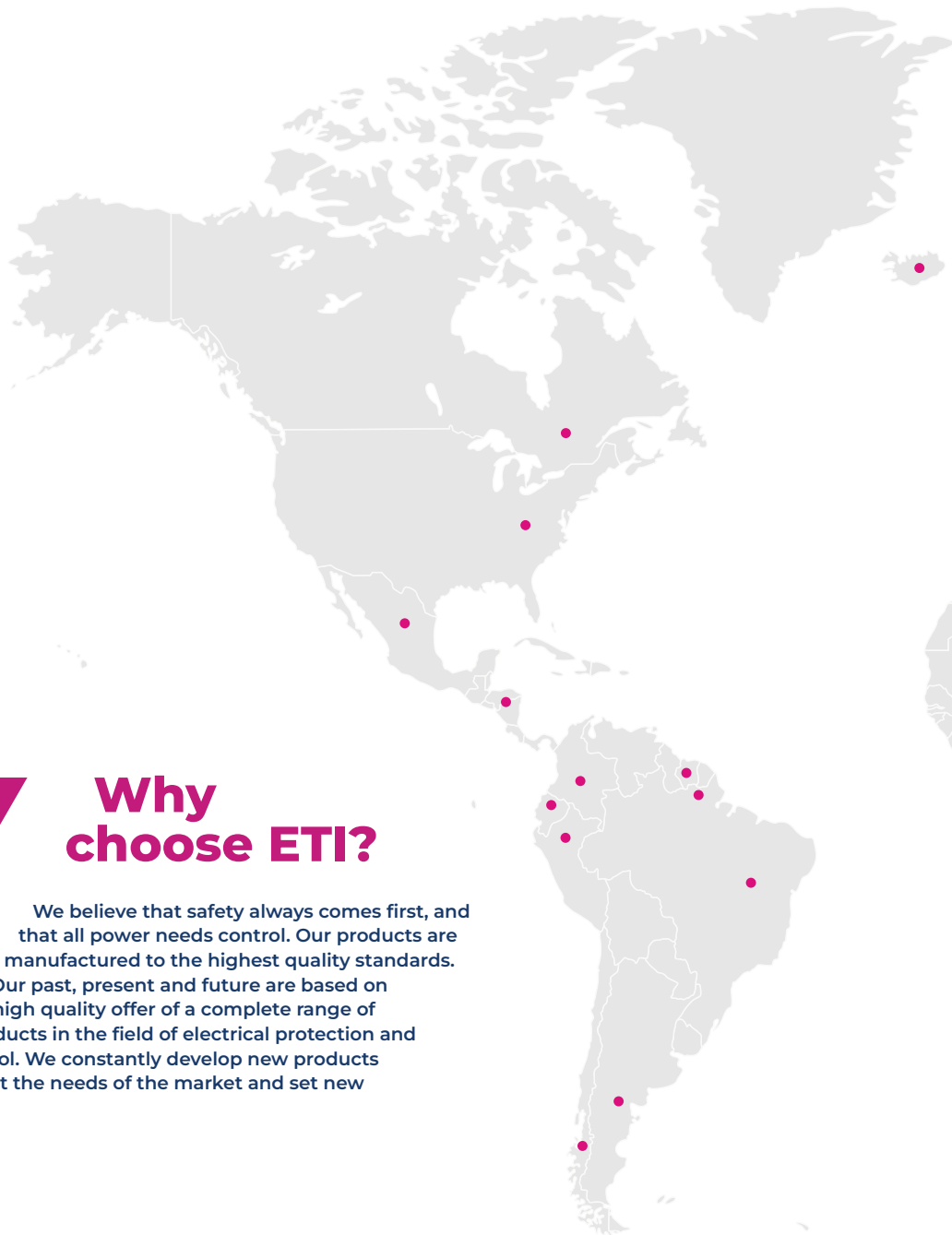

Why choose ETI?

We believe that safety always comes first, and that all power needs control. Our products are manufactured to the highest quality standards.

Our past, present and future are based on a high quality offer of a complete range of products in the field of electrical protection and control. We constantly develop new products to meet the needs of the market and set new trends.



 etigroup
www.etigroup.eu

ETI Elektroelement d.o.o.
Obrezija 5
1411 Izlake
Slovenia, EU

SWITCH TO
A SAFE FUTURE